



Thank you for your purchase!

We are delighted that you've chosen
GoPresence!

We've prepared some **tips to make your video meetings even better** and a **quick installation guide** (on the back of this card).

We hope you have an incredible experience with this equipment.

Thank you for choosing GoPresence.

GoPresence
www.gopresence.com
+1 (407) 544-0401
hi@gopresence.com



Scan to visit our website!

Check out the tips we've prepared for you:

- Avoid positioning the camera towards a window, as this can affect the lighting of the room. If this is not possible, use blackout curtains and rely on artificial lights.
- Instead of using Wi-Fi, connect an Ethernet cable to your computer/laptop. The connection will be more stable.
- Suggest that all participants mute their microphone while they are not speaking.
- We recommend acoustic treatment with absorption panels and diffusers to minimize reverberations. This will optimize audio reproduction and capture, ensuring a clearer and more professional sound.
- The camera and TV should be installed based on your eye-level, so that remote users have the impression that local users are looking directly at them. We recommend installing the TV based on the height of your table top.

Quick installation guide



GoPresence Teams

1. Connect the camera to the hub using the MiniDIN6 cable.
2. Connect the microphone to the hub using the MiniDIN6 cable.
3. Connect the hub to the laptop/desktop using the USB cable.
4. Connect the hub to a power outlet and turn it on.
5. The camera head will move and turn on the front light, indicating that the device is on and working.
6. Open the video conferencing application of your choice and start your meeting.

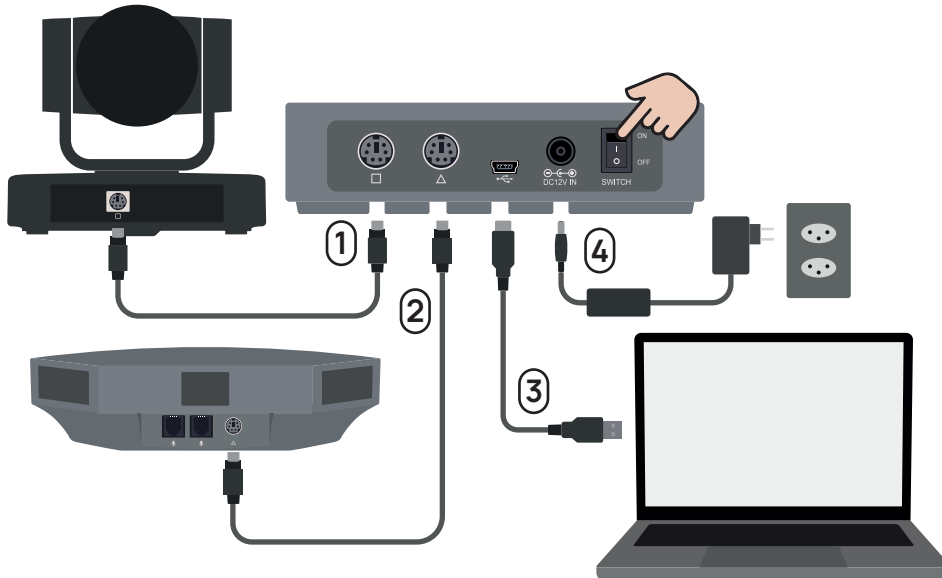

Warning !

- Do not move the camera head manually while it is on.



Scan to access our website
www.gopresence.com

If you have any questions, please
contact us: support@gopresence.com